

**Notes:**

1. Contractor shall call Iowa One Call to verify the location of any existing utilities.
2. Contractor is responsible for all grading and excavation work needed to install steps per plans.
3. P.C. Concrete steps to be built per plans. P.C. Concrete to be a C-4 mix per SUDAS specifications.
4. Install railings per plans.
5. Construction shall meet 2010 ADA Standards for Accessible Design.
6. Construct railings per plan.
7. Owner will finish grade site and seed once steps and walk are done.

**Lower Paver Patio**

8. Railing to be bolted down through steel face plate welded at bottom of each post with two 5/8" holes to accept "red head" style conc. anchor bolts. Anchor bolts to be 5 inch length with 4 inches into concrete.
9. Paint railing "safety yellow".

**Park Roadway**

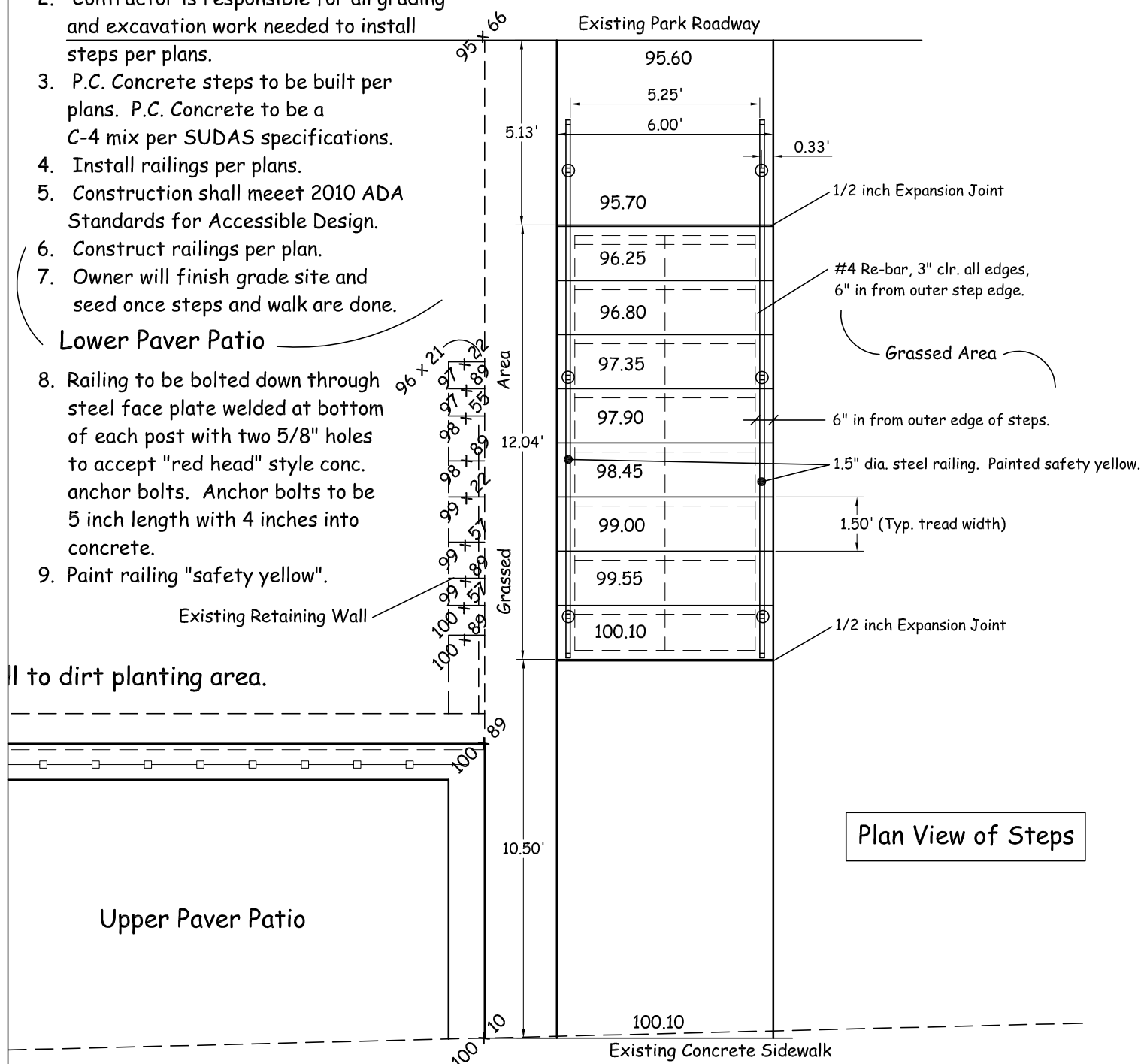

Plan View of Steps

**Bever Park  
Old Mc Donalds Farm  
Teaching Gardens**

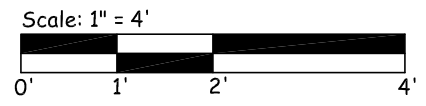

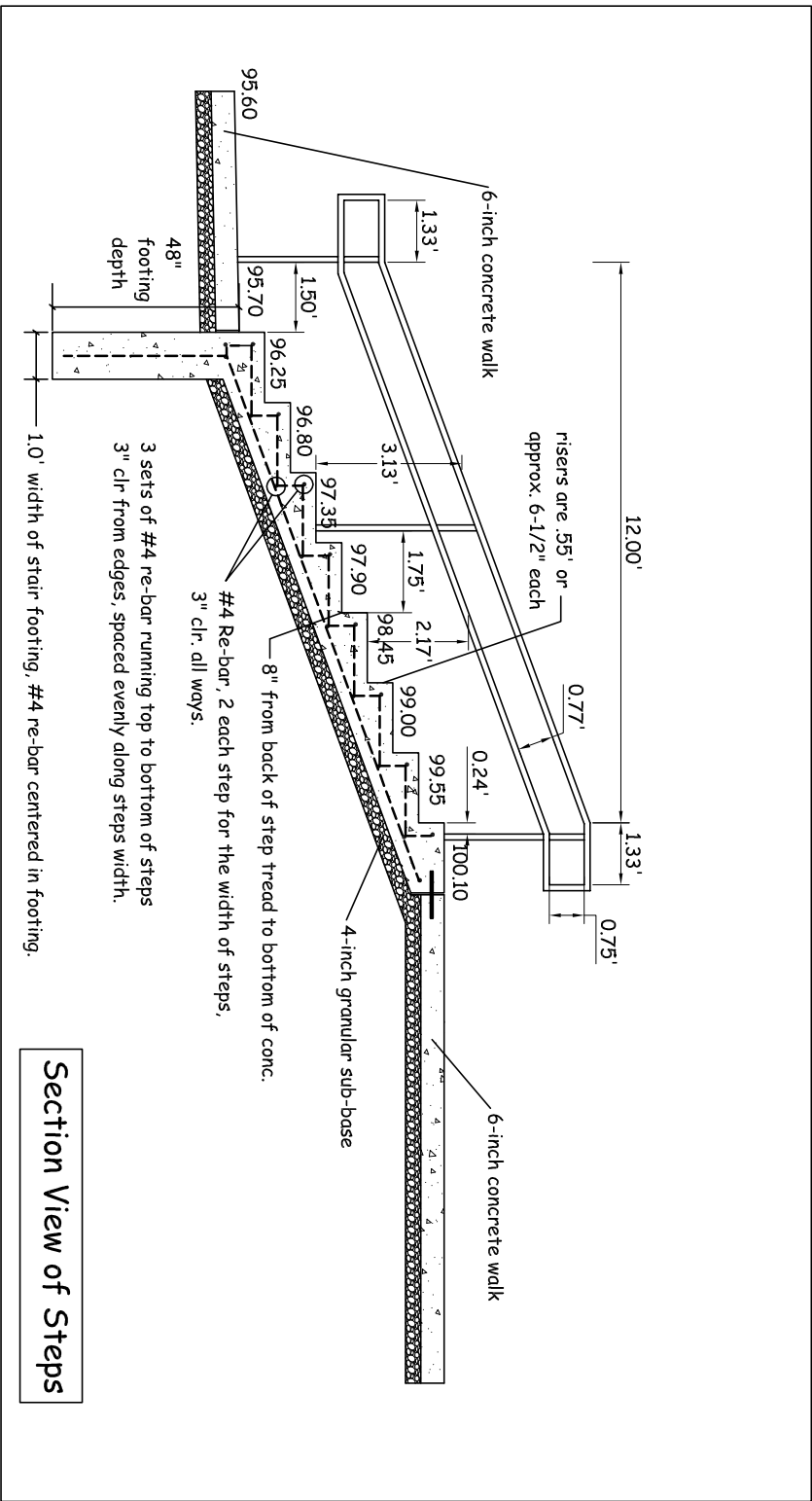

**Section View of Steps**

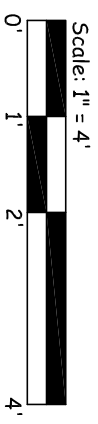

**Bever Park  
Old Mc Donalds Farm  
Teaching Gardens**